



Volume 8, Number 4

April 2024

The NMRA's **Turntable** is a monthly publication that, like a railroad turntable, will lead you in several directions on the internet.

This e-publication is a collection of railroad and model railroad videos, podcasts, websites, and/or other information freely available on the internet that we think may be of interest to you. The NMRA claims no ownership of this information, nor do we endorse its creators or their websites. The *NMRA Turntable* will not promote individuals or their for-profit ventures.

Having trouble seeing this email? [View as Webpage](#)

Blending Computer-Printed Photos



[Blending Photos Into Layout Backdrops](#)

Mosquito Creek Lumber Company shares with you how they integrate home computer-printed photos into painted background panels on their bedroom-size On30 narrow gauge layout. With simple materials and cheap craft paints, you can blend these photos into the background to create interest and depth to your scenes.

Finger Lakes Railway Layout OPS





Finger Lakes Railway Layout OPS

Switching the railway's new corn syrup cars at Seneca Foods on the Finger Lakes Railway layout.

Equipment Video #1—PGE/BCR 40ft Boxcars

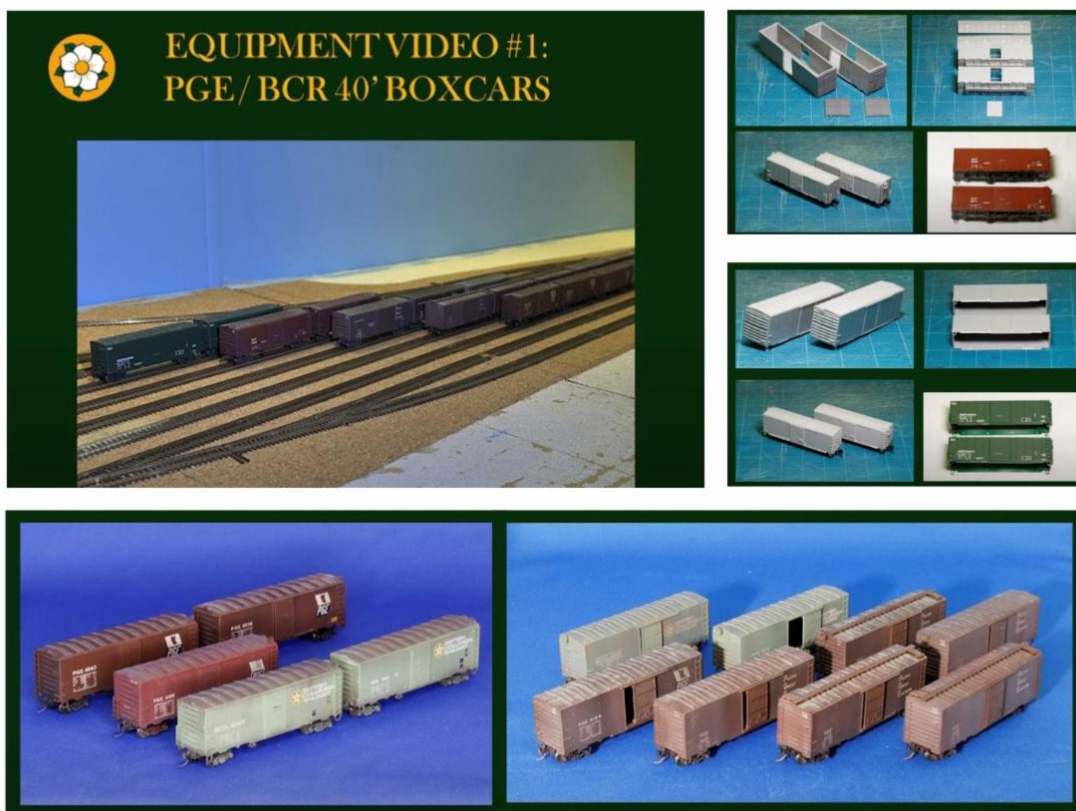

Equipment Video #1—PGE/BCR 40ft Boxcars

The first in a new series of videos focused on modelling the British Columbia Railway's locomotives and rolling stock! This video covers the 40' boxcars and efforts to model them in N Scale, including some comments for HO Scale where relevant.

39th Annual Narrow Gauge Convention



39th Annual Narrow Gauge Convention

Fun was had at the 39th Annual Narrow-Gauge Convention that was held this year in Sacramento, California. Shown here are some of the layouts, models and dioramas that were at the convention.

The Model Railroad Fantasy...



Prototype VS Model Railroad



...& the SRY Rail Link Reality

The idea of finding happiness with a large unachievable model railroad is extremely rare. Everyone thinks they are the exception when in fact most are the rule. Large layout nirvana is a myth perpetuated by the idea that a new locomotive will somehow solve the problem. In retrospect, it was the inevitable poorly planned and overly ambitious idea that killed the layout concept before it ever had a chance to become a reality.

In former cases, the only way to invigorate or sustain interest in a poorly planned, and overwhelming layout, is to keep buying trains to sustain a fleeting interest that is headed to inevitable burn out and overwhelming procrastination - only to repeat the same process - over - and - over again. The only solution in many cases is to re-plan and start again - unfortunately. In most cases, you will be glad you did because we all go through it.

This video demonstrates how the above dilemma was overcome. A smaller layout offers all the same benefits as a large layout on a more intimate footprint. They don't overwhelm the builder and also help to achieve success and confidence based on achievable goals. The rewards come sooner, rather than later, and can be quite remarkable.

Plant a Structure on Your Layout

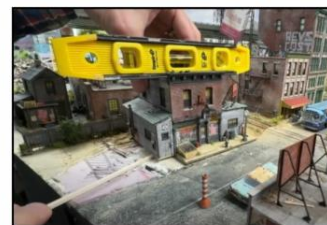



Plant a Structure on Your Layout

This video shows the process of "planting" a structure into the scene. There is more involved with making a structure look right than just setting it on your layout! Follow along as the structure is leveled and the ground scenery is built up around the model making it an integral part of the scene.

Foaming in Sacramento...



...& the California Railroad Museum

Come along with *Hyce* on his first-time visit to the California State Railroad Museum in Sacramento, CA.

The museum is home to the 'Magic of Scale Model Railroading' exhibit, which was built several years ago solely from NMRA member donations. This is an excellent museum and well worth a visit!

Size Does Matter!

The Importance of Scale

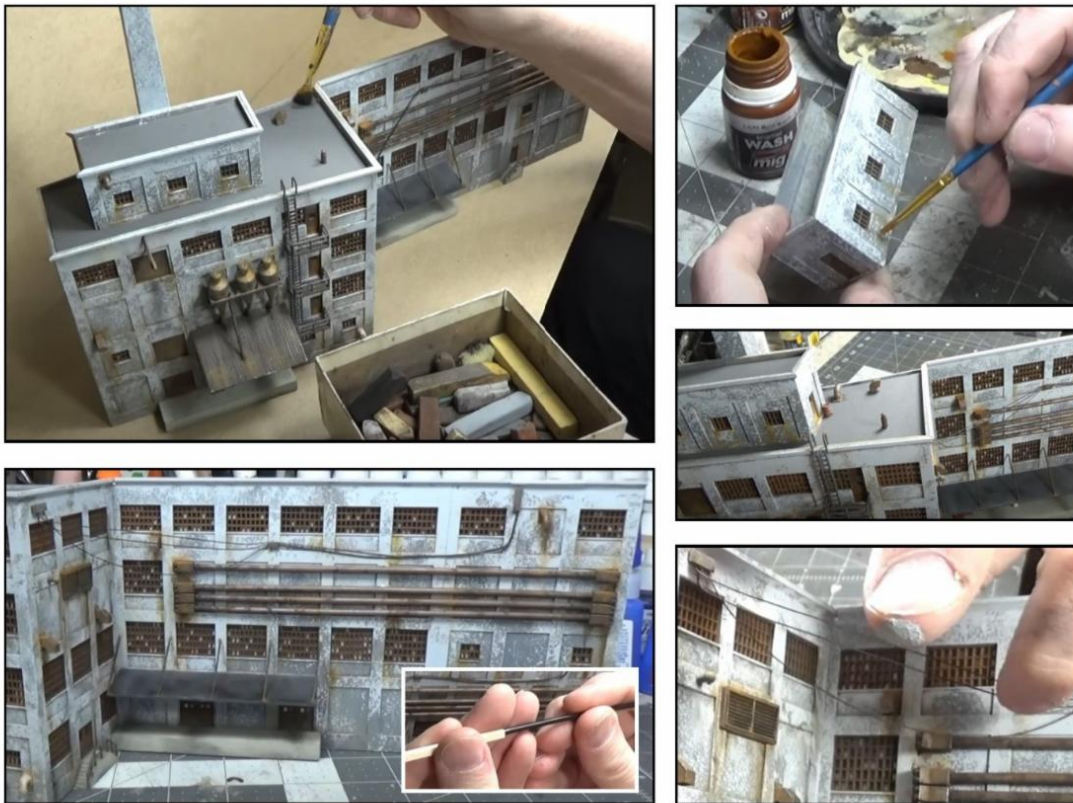

Size Does Matter!

In this video, Jason Jensen covers lots of tips and techniques while discussing the importance of scale in applying them!

Metcalfe N Scale Old Grimy Mill



Metcalfe N Scale Old Grimy Mill

A review of the Metcalfe Old Grimy Mill and Industrial Overbridge N scale models. More really useful budget buildings.

NMRA-x YouTube Channel

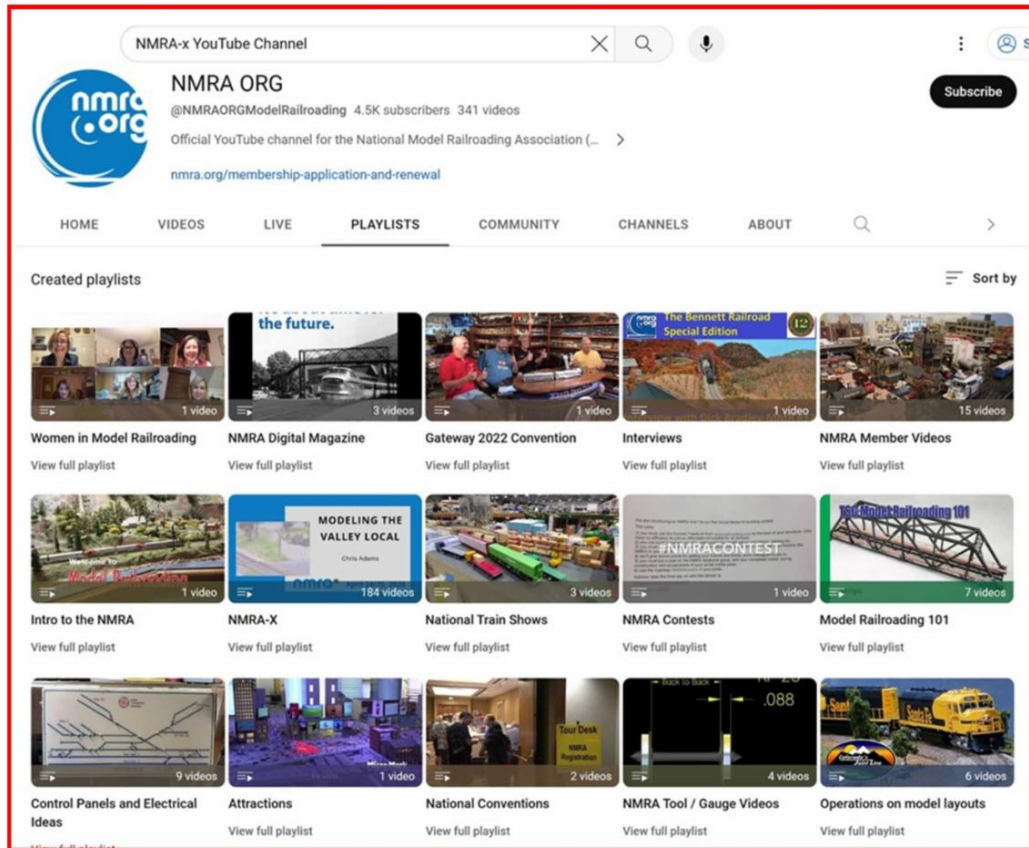

NMRA-x YouTube Channel

North Coast Limited 2024

The Mid-Central
Regional Convention
May 16-19 2024
Cleveland, Ohio



www.northcoastlimited2024.org

Convention Merchandise

*The North Coast Limited 2024 Convention offers two
Convention Cars and a Large selection of Men & Women's
apparel*

SCHEDULE of EVENTS
Layout Tours, Operating Sessions, 4 Clinic Rooms
(including make & take clinics for a small fee)
Celebration of Modeling, Yard Sale, Prototype Tours, General interest Tours,
Non-Rail Tours

Mid-Central Region Convention

Building an S Scale Junkyard Diorama



S Scale Junkyard Diorama

A lot of techniques can be seen in this video, including concrete making, weathering metal and plastic parts, making rust, making crushed cars, car press, scrap metal crusher and more. The diorama is modeled in 1/64 or S scale.

Peco Double Slips & Points

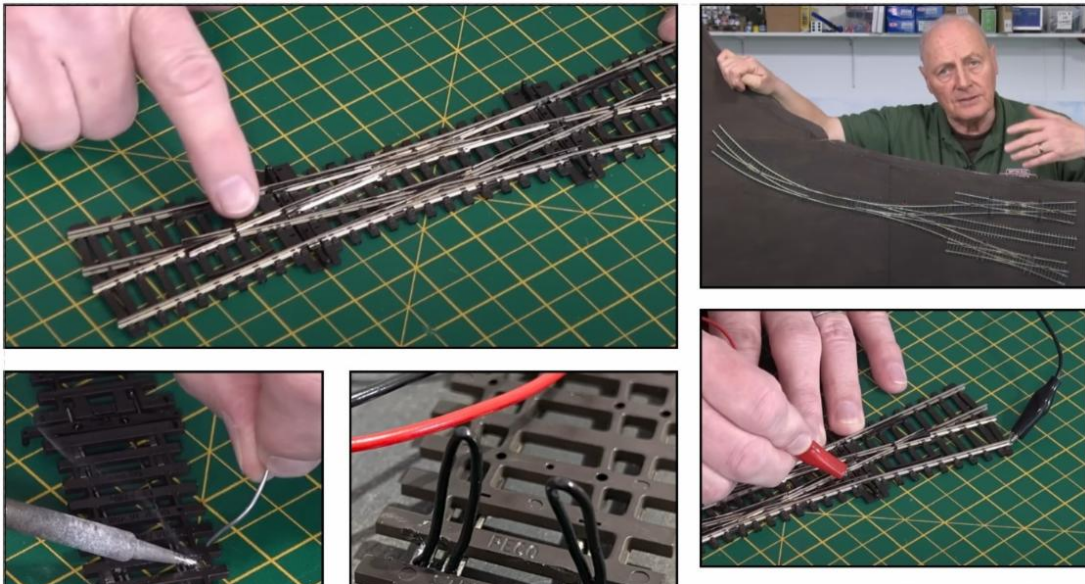

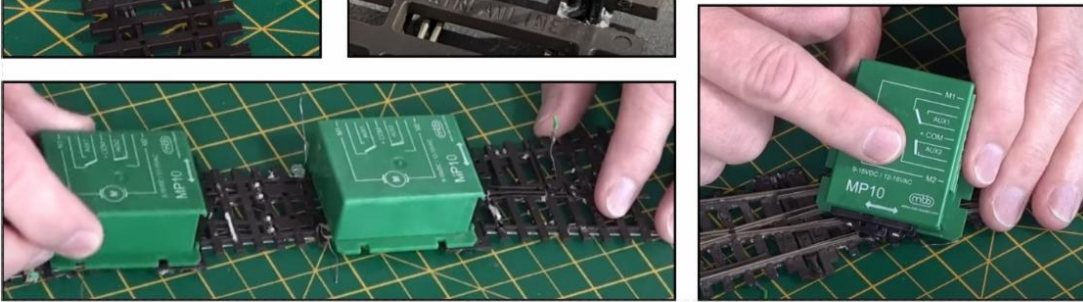

Peco Double Slips & Points

Installing Peco Double Slips and Points (turnouts in the US) can be confusing. Let Chadwick Model Railway 220 dispel any myths.

Railfan Hotspot—Decatur, Alabama



Railfan Hotspot—Decatur, Alabama

A video from six years ago on Danny Harmon's North Alabama adventure when he stopped at Decatur, AL. This is a MUST SEE for any railfan! Lots of traffic and a spectacular river crossing.

SouthEastern Region Convention 2024



SER-NMRA Annual Convention
June 20 to June 24

Decatur DoubleTree is offering a Special Group Rate of \$115/night.

LAST DAYS: JUNE 3rd to BOOK the special rate of \$115/night!
MAY 1st to REGISTER at the EARLY \$65 price!
(\$75 after May 1st)

Join Us In Beautiful Decatur

Summit in Decatur, Alabama for River Rails 2024

The Mid-South division invites you to join us in Decatur to enjoy the clinic, model, prototype, and non-rail activities at the Southeastern Regional Convention.



DoubleTree by Hilton Hotel
Decatur Riverfront
1101 6th Ave NE
Decatur, AL 35601
(256) 355-3150

SouthEastern Region Convention

In addition to the convention's website, you can watch a short convention [promo video](#) on what will be happening at the upcoming River Rails 2024 SER Convention! Click on the graphic above to go to their convention's website.

New Athearn SD70ACe Review



New Athearn SD70ACe Review

Product Reviews of both the new Athearn SD70ACe along with the Athearn ACF 4600 Covered Hoppers.

The Surf Line

SoCal's Major Passenger Rail Corridor



The Surf Line

After **CoasterFan2105** got many requests last year, this full version of the Surf Line video was made. Everything is pretty much the same as the 5-part series that was released last year with the one notable difference that there is no narration - just the sound of the trains rolling by. Some minor tweaks were made to the length of some of the clips and some of the static shots that were featured during some of the longer sections of narration were removed. (A video by Mike Armstrong Media.)

What's Neat This Week in Model Railroading



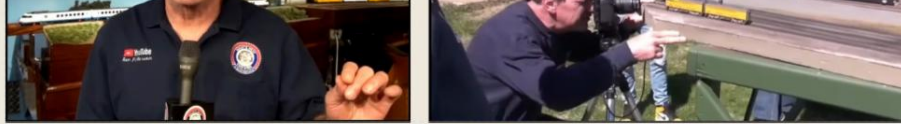

What's Neat This Week

This week Ken Patterson has Curtis Koch from Broadway Limited Imports and Jordan Smith from Rapido Trains with all the new product announcements for this week. Discussed are layout construction, working with foam and planning building placement on a layout. Also looked at is Oak Hill Model Railroad Track Supply's new turnout and track detailing components for realistic track. Check out the new VIA Passenger train from Bachmann. That and so much more in 1 hour and 15 minutes this week.

SurfLiner 2024 - NMRA National Convention



SurfLiner 2024 in Long Beach, CA

A great convention needs an amazing location, and our hotel is the Westin Long Beach in downtown Long Beach. The Westin Long Beach is just two blocks from the beach, harbor, and pier. Directly across the street is the Center for Performing Arts and the Long Beach Convention & Entertainment Center.

This just in:

The following Prototype Tours are now available for registration:

- Southern California Railway Museum - Monday August 5
- Los Angeles Union Station - Tuesday August 6
- Travel Town Museum / Rail Giants Museum - Wednesday August 7
- Metro Rail Fleet Services / GEMCO Yard - Thursday August 8

and General Interest Tours are now available for registration:

- Warner Brothers Studios - Monday August 5
- San Antonio Winery - Tuesday August 6
- Academy Museum of Motion Pictures - Thursday August 8
- Petersen Automotive Museum - Thursday August 8
- More General Interest Tours coming soon!

For more information on these tours click on the Surfliner 2024 link above.

Sign up for these tours when you register for the convention, or if you have already registered you can modify your registration to add any of these tours.

The Convention Team looks forward to seeing you in August!

SurfLiner 2024 - NMRA National Convention



[Surfliner 2024 Promotional Video](#)

NMRA's Partnership Program



PARTNERSHIP PROGRAM

NMRA members can log in and click on the **Benefits** tab to view the **NMRA Partnership Program**. Please patronize all of our partners for some fantastic discounts as an NMRA member!

Bespoke Rail	Ipswich*	R & J Details
CatzPaw Innovations	ITLA Scale Models	Scale Model Plans
CB Train Junction	K.I.S.S Method, Inc.	Scale Railroad Models
Clever Models, LLC	LaBelle Woodworking Co.	Scenery Solutions
Coastmans Scenic Products	LARC Products	Showcase Miniatures
Composite Designs, Inc.	Logic Rail Technologies	T-Trak by Denniston
CMR Products, LLC	MAC Rail	Team Track Models
Conowingo Models	Micro-Mark	The N Scale Architech
Cowcatcher Magazine	Mine Mount Models	The Old Depot Gallery
Daylight Sales (Merchandise)	Miniprints	Tichy Train Group
Deepwoods Software	MrTrain.com	Touch of the Brush Model
Deluxe Materials	Model Railroad Benchwork*	Weathering
Diorama Hobbies	MRC (Model Rectifier Corp)	Train Installations, LLC
Dwarvin Enterprises, Ltd	Model Train Catalogue	Train Show, Inc.
East Coast Circuits	Modelers Decals & Paint	Trainmasters TV/Model
Enterprise and National Car	Motrak Models	Railroad Hobbyist Store
Rental Services	Mudd Creek Models	TRAINZ.com
Evan Designs	New Creations Victorian	TSG Multimedia
Feight Studios	Railroad Buildings	UGEARS
Fusion Scale Graphics	Nick and Nora Designs	USA Airbrush Supply/
Gatorfoam	Northlandz	Badger Airbrush
Great Decals!	NScale Works by Mike Holly	WiFi Model Railroad, LLC
Green Frog Productions	Old Depot Gallery	Yelton Models
Highways and Byways Model	Old West Scenery	
Railroad Graphics	RAM Track	
Hot Wire Foam Factory	RR-CirKits	

[New Partners in RED*]

April 2024

[Partnership Program](#)

The NMRA Partnership Program is a member benefit that truly has a tangible payback. We've partnered with model railroad manufacturers of all sizes, giving them exposure on our website in return for

receiving generous discounts for NMRA members all year long. Some provide members with special codes, others prefer a phone or email order, but all appreciate the additional business from our members. And of course, our members appreciate the extra savings...savings that can actually pay the cost of NMRA membership!

Also, be sure to check back often as new Partners are being added all the time!

Our two new Partners this month:

New Partner Model Railroad Benchwork Store

The National Model Railroad Association is excited to announce the Model Railroad Benchwork Store as our newest NMRA Partner!

15% OFF FOR NMRA MEMBERS

 national model railroad association

Visit our website
www.nmra.org/partnerships

Free-Mo Modules

T-TRAK Modules

NTRAK Modules

MODEL RAILROAD BENCHWORK STORE
MODEL RAILWAY TECHNIQUES.COM

Benchwork and Train Tables

Model Railroad Benchwork Store

Model Railroad Benchwork Store is a producer of Benchwork Kits, T-TRAK Modules, NTRAK Modules, Free-Mo Modules and Train Tables.

New Partner - Ipswich Hobbies



IPSWICH HOBBIES

The National Model Railroad Association is excited to announce Ipswich Hobbies as their newest NMRA Partner!

**10% OFF FOR
NMRA MEMBERS**



Visit our website
www.nmra.org/partnerships

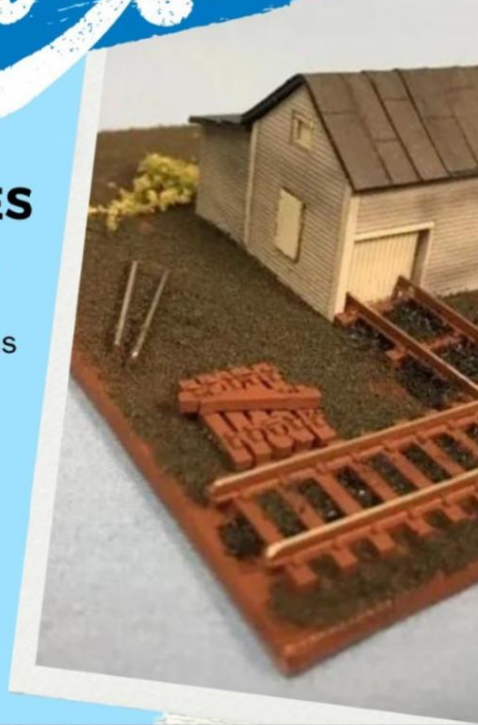

Ipswich Hobbies

Ipswich Hobbies is a small company that focuses on delivering laser cut craftsman building kits that are based upon prototype structures.

Each of their kits is created with maximum fidelity to the original structure. Some of the prototypes are long gone; some are seriously compromised by years of neglect; some have been faithfully restored. Minor compromises are to allow for commercially available parts or selective compression to fit available model railroad layout space.

2024 Thousand Lakes Region Convention

Presented by the of the NMRA

Sleep Inn & Suites Conference Center | Eau Claire, MN | May 16 -19



2024 Thousand Lakes Region

NMRA@HOME



Railfanning a B&O HO Empire

Featured in the Division Business Car Column appearing in the April 2024 issue of NMRA Magazine.

The Cincinnati Division of the Mid Central Region published a layout tour of John Listermann's B&O Fairmont Division in its newsletter, *The Oil Can*. John's club-sized layout depicts the railroad as it would look during the steam to diesel transition era.

Building a Craftsman Kit, Part 2

Featured in the Division Business Car Column appearing in the April 2024 issue of NMRA Magazine.

Jack Ellis of Bar Mills continues to share his techniques on building craftsman kits in the Niagara Frontier Region's Western New York Division newsletter, *The Lantern*. In this issue, Jack shares tips on painting, detailing and weathering, stucco, brick, and stone structure walls. You can find Part 1 below.



Building Switch Lists

Featured in the Division Business Car Column appearing in the April 2024 issue of NMRA Magazine.

David Paul, a member of the 100% NMRA San Jacinto Model Railroad Club of Houston Texas, explains how he uses Microsoft Excel to create his switch lists in the January issue of the club's newsletter, *The Derail*.

NMRA @ HOME

The **Division Business Car** column appears in even-numbered months in NMRA Magazine. It's loaded with great modeling ideas, plus useful information that can help make your Division, Region, or 100% NMRA Club even better. The information comes from articles published in Region, Division, and Club newsletters. The best of these articles are posted on the NMRA website. You can read the entire archive, from as far back as 2011 right up to the latest posting, by clicking [here](#).

Previous issues of the **NMRA Turntable** are available on the Turntable Archives page. You must first log in as a member at: nmra.org After you are in the members-only section, then you must hover over 'Publications' on the menu bar, then 'NMRA Turntable', and then click on one of the list of back issues.

Editor: [Paul Voelker, HLM](#)

Executive Editor: [Rick Coble](#)

The NMRA Turntable is an official monthly production of the National Model Railroad Association, Inc. Publishing Department ([Riley Triggs](#) Manager). Its purpose is to introduce NMRA members to a selection of instructional videos and online publications that they may find of interest. If you know of an NMRA member who is not receiving this mailing, please direct them to [here](#) to update their email address. If you no longer wish to receive these mailings, please don't mark them as SPAM. Instead, click the Safe Unsubscribe link at the bottom of this page. ©2021 National Model Railroad Association, Inc., P.O. Box 1328, Soddy Daisy TN 37384.

